

DESCRIPTION

Fixed caliper with 2 opposed pistons, realized by semicalipers joined by bolts. Pads are supported by one pin. Construction Material: Aluminium Alloy. Operating fluid: brake fluid DOT4.

PADS SHAPE AND DIMENSIONS

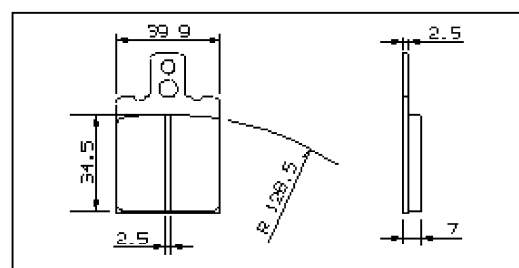

TECHNICAL CHARACTERISTICS

Pistons number and diameter	2	32mm	Average pad surface (1 pad)	13.3 cm ²
MAX working pressure		70bar	Weight (with not sintered pads).	0.520 Kg
A) Disc position (TOLERANCE).		±0.3 mm		

CONFIGURATION

CHARACT. CODE CALIPER	PADS FRICTION MATERIAL	BODY COLOR	MOUNT. SIDE	USABLE DISCS THICKNESS	BRAKE FLUID FOR PADS WEAR
20.5185.21	FERIT 1/D 450 FF	GOLD	SX DX	5.0 mm 4.6 mm	6.50 cm ²

AVAILABLE SPARE PARTS

SPARE PARTS CODE CALIPER	PADS	BLEEDER SCREW	DUST COVER	PIN	COVER
20 5185.21	107.2688.25	105.3246.11	105.1502.10	120 2800.30	120 2688.20