

“SE” FORK KIT

YAMAHA FZ6 600 ‘04 > FZ6 600 S2

“SE” FORK KIT COMPONENTS

- | | |
|----------------------|------------------|
| A– Piston group | B– Spring kit |
| C– Spring guide bush | D– Spacer kit |
| E– Fork plug group | F– Original bowl |

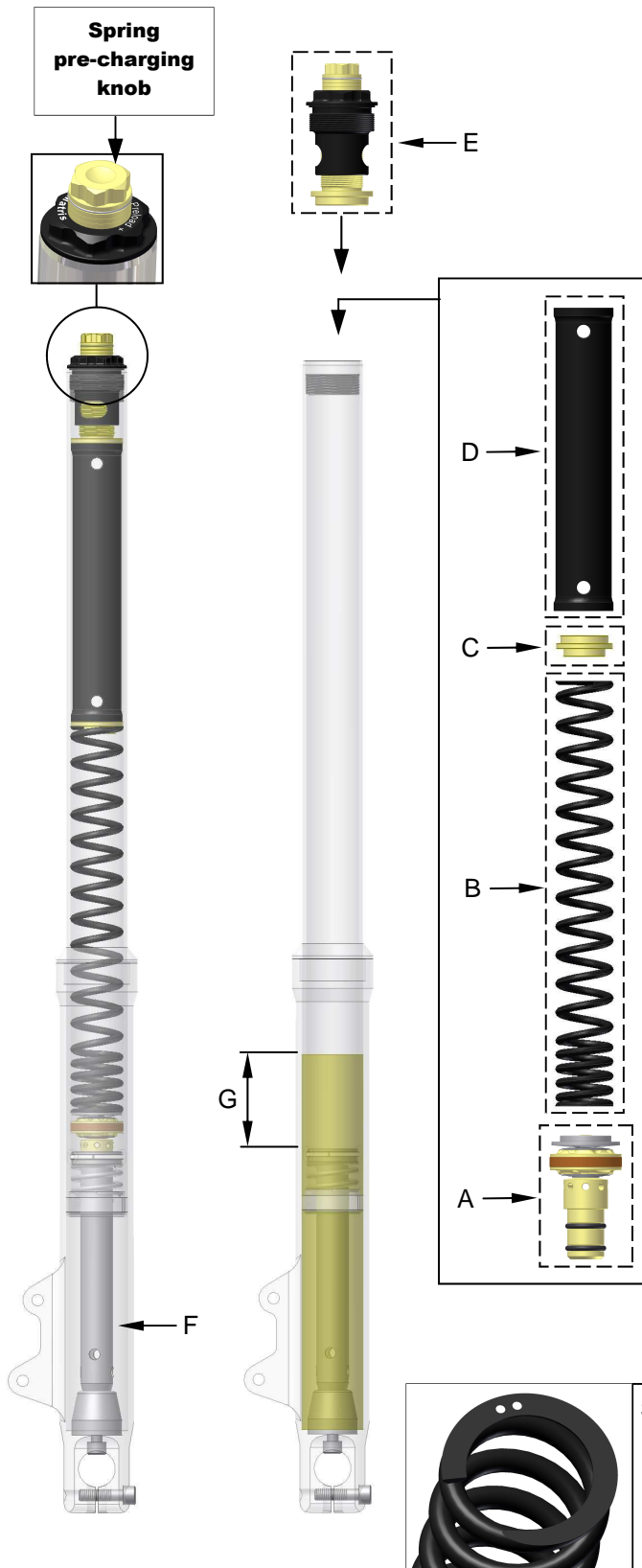

ASSEMBLY PROCEDURE

- 1– Carefully remove the fork so as not to damage the oil seals and the sliding sockets
 - 2– Clean thoroughly the crossbar, fork and the various original components
 - 3– Grease thoroughly the parts subject to sliding and remount the oil seals and sliding sockets on the sheath
 - 4– Remount the original bowl “F” with all its original end-of-travel components
 - 5– Slowly fill the fork with oil (supplied with the kit) until the original bowl “F” is completely soaked thereby creating a vacuum above it, indicated by the letter “G”, while holding the crossbar completely extended so as to allow the piston group “A” to be completely soaked at application time which will take place later
 - 6– Start working on the draining phase by moving the fork up and down at a moderate speed so as to eliminated possible air pockets
 - 7– Position the piston group “A” inside the original bowl “F” making sure that it is completely soaked in oil so as not to create air pockets
 - 8– Now take the oil level at **160.00 mm**, which is the recommended level while holding the crossbar in idle position, all way down
- Note:** the level of the oil is measured from the top of crossbar to the beginning of the oil
- 10– Position the kit components in the following sequence:
 - “B” kit spring
 - “C” bush guide spring
 - “D” spring spacer
 - 11– Screw on the fork plug group “E” thereby completing the operation

Spring point ref.

- = K 8.5
- = K 9.0
- = K 9.5